

WireCrafters®

WOVEN WIRE PARTITIONS

STYLE

840



it's what you make of them!



more great ideas inside...

WireCrafters

Style 840

The amazingly versatile woven wire partition.



System Benefits

The Proven Style of Today's Wire Partition

For over 35 years, Wire Crafters has manufactured what we feel is the "Very Best Woven Wire Partition." Contrary to traditional systems, our Style 840 is based on the simple idea that panels stack one on top of the other between tubular posts to reach the finished partition height. This all-welded, modular, stackable system has benefits unequaled in the industry.

The Style 840 Solution

- **MODULAR DESIGN**
Twenty basic panels and our "building block" approach accomplish virtually any layout.
 - **FAST INSTALLATION**
Fewer parts than standard partition systems. Angle frames give clear access to all mounting hardware.
 - **STRONG**
Panels bolt directly to support posts. Standard 3/8" wedge anchors hold partition firmly in place. Base plates welded on posts allow direct floor anchoring.
 - **CLEAN DESIGN**
Straight lines and clean exterior makes a handsome finishing touch.
 - **FLEXIBLE**
Easy to reconfigure as needs change.
- Stock items are available for shipment within 48 HOURS OF YOUR ORDER.**

Style 840 System Benefits	1
Panels & Posts	2
Hinged Doors	3
Doors & Windows	4
Ceilings and Door Openers	5
Standard Locks	6
Custom Locks	7
Pallet Rack Back	8
Pallet Rack Enclosures	9
Physical Barriers	10
Alternative Materials	11
Also Available:	
MezzaRail Mezzanine Railing	12
Storage Lockers	12
DEA Storage Cages	12
Guard Rails	12
Estimating Worksheet	13
Style 840 Specs	14
Color Chart	14

Panels & Posts

Simple, economical, modular design

Panels

MODULAR PANELS

- Ten widths, 1' to 10' in one foot increments.
- Two heights: 4'-0" and 5'-0"
- Full height partition walls are built by stacking two or more panels between posts.
- Mesh: 10 gauge wire woven into 2" x 1" rectangular openings.
- Frame 1-1/4" x 1-1/4" x 1/8" steel angle.
- Custom size panels available.
- Alternate meshes available, see page 11.

ADJUSTABLE PANEL

- Solid sheet metal panel.
- Fill small gaps in runs.
- Allows for adjustment from 1" to 11".
- Ideal for hard to measure areas.
- Two heights: 4' and 5' match panel heights.

WOVEN WIRE PANELS 4 Ft. High

Part No.	Width x Height	Weight
104	10'-0" x 4'-0"	63
94	9'-0" x 4'-0"	58
84	8'-0" x 4'-0"	53
74	7'-0" x 4'-0"	46
64	6'-0" x 4'-0"	41
54	5'-0" x 4'-0"	36
44	4'-0" x 4'-0"	31
34	3'-0" x 4'-0"	23
24	2'-0" x 4'-0"	18
14	1'-0" x 4'-0"	13

WOVEN WIRE PANELS 5 Ft. High

Part No.	Width x Height	Weight
105	10'-0" x 5'-0"	74
95	9'-0" x 5'-0"	68
85	8'-0" x 5'-0"	63
75	7'-0" x 5'-0"	54
65	6'-0" x 5'-0"	48
55	5'-0" x 5'-0"	42
45	4'-0" x 5'-0"	36
35	3'-0" x 5'-0"	27
25	2'-0" x 5'-0"	22
15	1'-0" x 5'-0"	16

ADJUSTABLE PANEL

Part No.	Width x Height	Weight
AP4	1' 3-7/8" x 4' 0"	13
AP5	1' 3-7/8" x 5' 0"	16

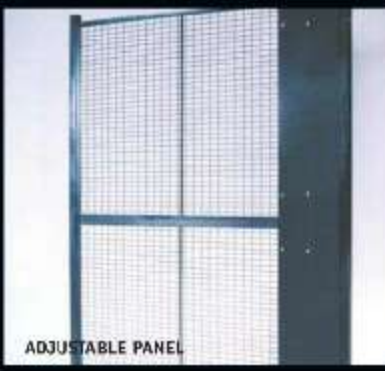

Posts

POSTS

- Stock sizes: 8'-5 1/4", 10'-5 1/4", 12'-5 1/4".
- Standard hole layout allows for 3-1/4" sweep-space.
- Posts project 2" above top of panel.
- Standard Baseplate: 2" x 7" with holes for anchors.
- Special length posts are available to 40'.
- Oversized baseplates are available.
- Floor anchors (3/8") are included with your order.

STOCK SIZE POST

Part No.	Height	Weight
RP-8		
Run	8'-5-1/4"	20
CP-8/TP-8		
Corner/Tee	8'-5-1/4"	21
RP-10		
Run	10'-5-1/4"	23
CP-10/TP-10		
Corner/Tee	10'-5-1/4"	24
RP-12		
Run	12'-5-1/4"	33
CP-12/TP-12		
Corner/Tee	12'-5-1/4"	33

Hinged Doors

Secured Access to Your Storage Areas



HINGED DOOR



DOUBLE-HINGED DOOR



DUTCH DOOR

HINGED DOORS

- 3' or 4' wide by 7' 3-1/4" high opening.
- Transom panel sized to match partition height.
- Three 4" x 4" 10 gauge tight pin hinges.
- Padlock lugs standard, cylinder locks available.
- Complete with two door posts and hardware.
- Universal construction, works for left or right hand, inside or outside swing.

DOUBLE-HINGED DOORS

- 6' or 8' wide by 7' 3-1/4" high opening.
- Inactive leaf secured by cane bolt (base) and chain bolt (top).
- Padlock lugs standard, cylinder locks available.
- Complete with two door posts and all hardware.
- Transom panel sized to match partition height.
- Custom size and no over head obstruction doors available.

DUTCH DOORS

Same as Hinged Door except:

- Two separate operating door leaves.
- Bottom leaf locks with padlock, cylinder lock available.
- Top leaf locks to bottom with spring bolt.
- 10 gauge shelf, 18" deep x door width fixed to bottom leaf.
- Must specify hand and swing of door.



STYLE 840 WOVEN WIRE DOORS

HINGED DOORS

Part No.	Opening Width x Height	Weight
HD-37-8	3'-0" x 7'-3 1/4"	106
HD-47-8	4'-0" x 7'-3 1/4"	118
HD-37-10	3'-0" x 7'-3 1/4"	123
HD-47-10	4'-0" x 7'-3 1/4"	139

DOUBLE-HINGED DOORS

Part No.	Opening Width x Height	Weight
DHD67-8	6'-0" x 7'-3 1/4"	170
DHD87-8	8'-0" x 7'-3 1/4"	193
DHD67-10	6'-0" x 7'-3 1/4"	190
DHD87-10	8'-0" x 7'-3 1/4"	217

DUTCH DOORS

Part No.	Opening Width x Height	Weight
DD37-8/Swing Out	3'-0" x 7'-3 1/4"	125
DD47-8/Swing Out	4'-0" x 7'-3 1/4"	142
DD37-10/Swing Out	3'-0" x 7'-3 1/4"	145
DD47-10/Swing Out	4'-0" x 7'-3 1/4"	166

Doors & Windows

A Wide-Range of Products to Fit Your Needs



SLIDING DOOR

SLIDING DOORS

- 3', 4', 5', 6', 8' or 10' widths.
- Full height partition openings of 8' and 10'.
- Padlock lug standard, cylinder lock available.
- Complete with two door posts, two 4 wheel trolley trucks, 16 gauge track, and all hardware.
- Universal construction, works for left/right hand, inside/outside.
- Custom sizes available.

Inset Photo: Our patented tamper-resistant sliding gate receiver.
U.S. Patent # 6196034B1

STYLE 840 WOVEN WIRE DOORS SLIDING DOORS

Part No.	Width x Height	Weight
SD-38-8	3'-0" x 8'-1/4"	124
SD-48-8	4'-0" x 8'-1/4"	137
SD-58-8	5'-0" x 8'-1/4"	149
SD-68-8	6'-0" x 8'-1/4"	196
SD-88-8	8'-0" x 8'-1/4"	230
SD-108-8	10'-0" x 8'-1/4"	279
SD-310-10	3'-0" x 10'-1/4"	149
SD-410-10	4'-0" x 10'-1/4"	168
SD-510-10	5'-0" x 10'-1/4"	185
SD-610-10	6'-0" x 10'-1/4"	234
SD-810-10	8'-0" x 10'-1/4"	277
SD-1010-10	10'-0" x 10'-1/4"	334



TUNNEL DOOR

TUNNEL DOORS

- Designed for no overhead obstruction.
- Leading edge of door rolls on floor casters.
- Rear of door hangs from door track.
- All sizes made to order.
- Ideal for high traffic areas, and overhead crane access.

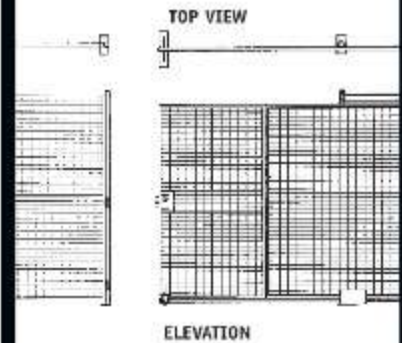

ELEVATION



SERVICE WINDOW

SERVICE WINDOWS

- Lockable, slide-up window secures opening when unattended.
- Window opening: 24" wide x 20-1/2" high.
- Shelf size: 24" wide x 18" deep x 10 gauge.
- Shelf height: 42-1/4" off of floor level.
- Panel size: 4'-0" wide x 8'-0" high; transoms extend height to 10' or 12'.
- Counter balanced, hinged, or mechanically operated windows in various sizes are available.

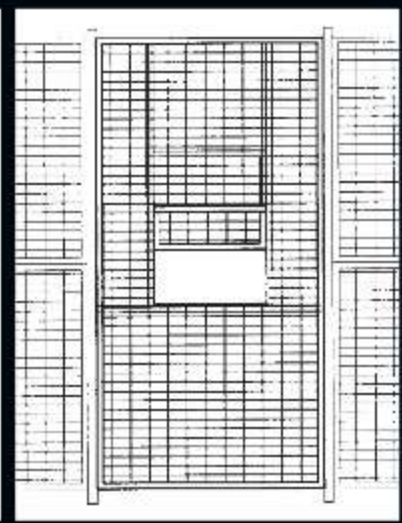

Ceilings & Openers

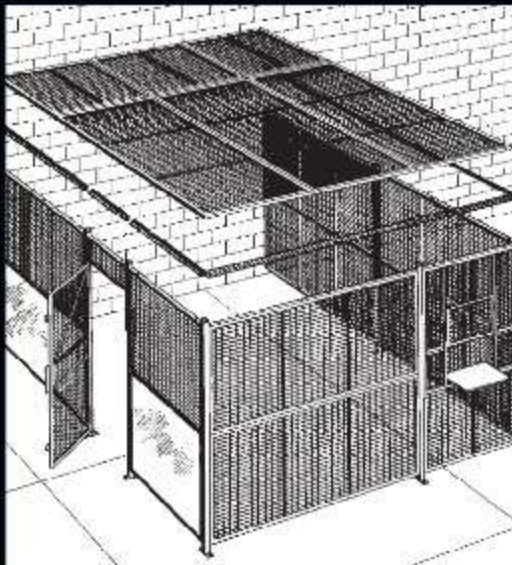

CLEAR-SPAN CEILINGS

- Ceiling panels interchangeable with wall panels.
- Attach to partition walls with slotted angle.
- Clear spanned up to 35'.
- Large ceilings supported by horizontal ceiling tubes.
- Add to existing partition without changing layout.
- All ceilings are non-load bearing.
- Ceiling cutouts or drop down doors available.

VERTICAL RISE GATES

- Sized to customer requirements.
- Gate slides up and out of the way.
- Counter balanced, pneumatic, and electric operators available.
- Often used with vertical lifts.
- Can be integrated with automated storage/retrieval systems.

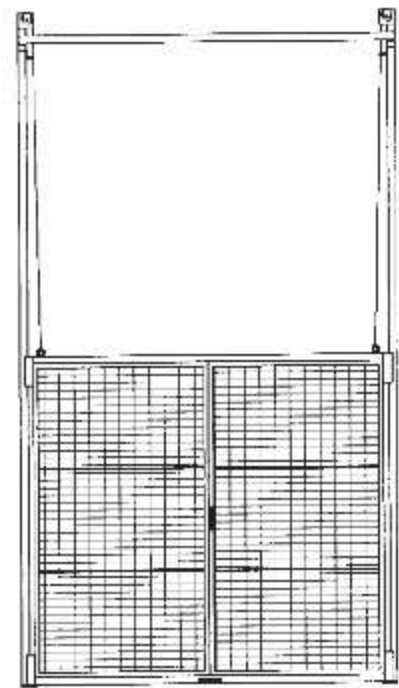

DOOR OPENERS AND SELF-CLOSING GATES



ELECTRIC DOOR OPENER Uses standard 110 volt single phase electric motor with rack and pinion drive. Supplied with radio frequency remote controls, self closing timer, anti-crush safety switch, and photo eye safety switch, stationary push button control, electro-magnetic locks optional.

PNEUMATIC DOOR OPENER
Requires facility supplied compressed air of 40psi. Cylinders operated by stationary palm button, lever valve, or electric solenoid. Works with vertical rise or slide to side gates.



HINGE DOOR CLOSER Commercial grade hydraulic door closer causes door to close and latch upon release.

SELF CLOSING SLIDING GATES
Requires no external power source. Counter balanced weight and pulley system closes and locks gate upon release.

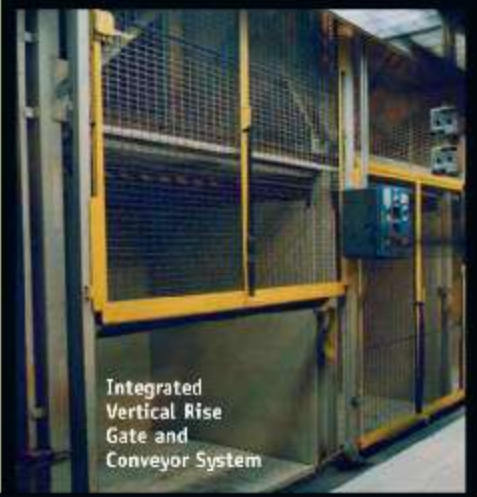
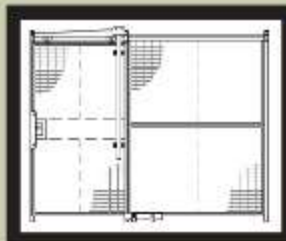

Integrated Vertical Rise Gate and Conveyor System

Standard Locks

Standard Fronts and Backs Ship Within 48-Hours.

STANDARD FRONT (SF-1)



ALTERNATE FRONTS



(SF-2) Thumb-Turn Latch... latches only, does not lock.



(SF-3) Door Knob Entry... latches only, does not lock.

ALTERNATE FRONTS work with any of the three backs shown below.

ALTERNATE BACKS work with any of the locks shown to the left.

STANDARD BACK (SB-1)



ALTERNATE BACKS



(SB-2) Interior Key... lock from both sides, keyed to match face side.



(SB-3) Door Knob... typical size door knob for easy exit.



(SB-4) Lever Handle... alternative to standard door knob. Meets ADA requirements.

keying options

STANDARD CYLINDERS:

- Standard locks are supplied keyed different.
- Keyed alike locks available
- Optional Master Key available

ALTERNATE CYLINDERS:

- Best Cylinder® Less Core
- Any 1" mortise cylinder



Put our lock "Know-How" to the test!

Let us know if you need a special locking device. We have experience with many different lock styles. Let us put our experience to work for you. Call toll-free today for more information, or contact the WireCrafters dealer nearest you. Call 800-626-1816!

Custom Locks

Makes a Great Product...Even Greater.

ELECTRICAL LOCKING DEVICES



(CE-1) Coded Card Reader...activates electric strike or magnetic lock upon insertion of coded card. Ten cards supplied. Requires key pad controller for card activation. Card readers available on hinged and sliding gates.



(CE-2) Ten-Digit Key Pad...operates electric strike or magnetic lock upon entry of four-digit pass code. Programmable up to 64 different codes. Numeric key pads available on hinged and sliding gates.



(CE-3) Electro-Magnetic Lock...magnetically locks sliding gates securely closed. Requires card code reader, ten-digit key pad or remote push button to operate. **Available for sliding gates only.**



(CE-4) Electric Strike...allows hinged gates to open when activated by encoded card, ten-digit key pad, or remote push button. Works with standard key locks. **Available on hinged gates only.**

LEVER HANDLES



(CF-1) Master Lock® ADA Handle...meets ADA requirements, available with or without key lock. (Key Lock shown)



(CB-1) Master Lock® ADA Handle...meets ADA requirements, available with or without key. (Twist button lock shown)

CODED ENTRY



(CF-2) Five-Button Coded Access Lock...code or key entry. Match with push paddle or thumb turn knob inside.



(CB-2) Push Paddle...hand-sized paddle for quick exit. Match with key or five-digit push button lock.

OTHER BACK OPTIONS



(CB-3) Push Bar...push bar runs full width of door. Match with key or five-digit push button lock.



(CB-4) Alarm Lock...sounds battery powered alarm when opened. Available with or without exterior key access.

Rack Back™

Pallet Rack Backing



"BACK ANY RACK" WITH WIRECRAFTERS MODULAR PANEL SYSTEM.

Sturdy framed panels provide hassle-free installation by bolting directly to rack uprights with our right angle mounting brackets. Panels may be extended above the rack with our "above-the-top" extension supports.

- Mounting brackets bolt directly to rack uprights, panels bolt to brackets.
- Off-set brackets allow for load to overhang rack beams.
- Creates sturdy barrier between stocked items and the ground below.
- System installs quickly, with standard nuts and bolts.
- Panels may be extended above the last beam to contain top loads.
- Backing may be started at floor, or at any level where protection is required.
- Prevents spills into walkways and other personnel areas.

POPULAR RACK BACK PANEL SIZES

Panels stocked in 1' wide increments. Custom sizes available – Call for details. Four brackets per panel are required for installation.

FOUR FOOT PANELS

Part No.	Width x Height	Weight
124	12'-0" x 4'-0"	77
104	10'-0" x 4'-0"	63
94	9'-0" x 4'-0"	58
84	8'-0" x 4'-0"	53

FIVE FOOT PANELS

Part No.	Width x Height	Weight
125	12'-0" x 5'-0"	90
105	10'-0" x 5'-0"	74
95	9'-0" x 5'-0"	68
85	8'-0" x 5'-0"	63

RACK BACK™ is easy to order

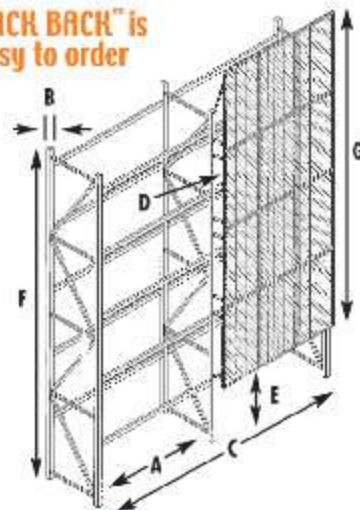

Fax or call with the following information and we'll fax back a quote and layout drawing in no time – most always on the same day.

- A Beam width between rack uprights
- B Upright width
- C Overall number of bays
- D Required offset dimension from upright to panel (to allow for pallet overhang)
- E Mounting height above floor (if not flush-to-floor)
- F Overall height of rack uprights
- G Desired backing height



OFF-SET MOUNT BRACKETS

Panels mount to the pallet rack upright with an offset bracket. Mounting brackets from flush mount to 12" off-set available. Four brackets are required per panel.

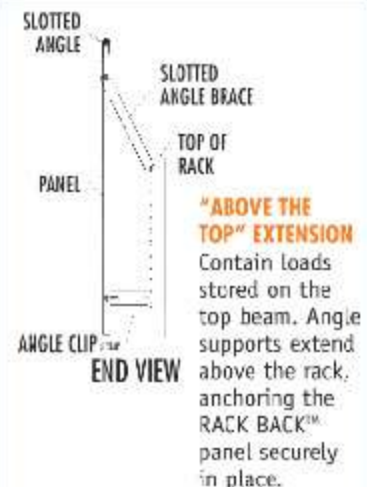

Rack Enclosures

Pallet Rack Back™ Enclosures



COMPLETELY ENCLOSE YOUR PALLET RACK SYSTEM AND SECURE INVENTORY!

It's so simple to add extra security to your pallet rack system with WireCrafters hinged and sliding gates. Control access and prevent inventory theft with our pallet rack enclosures.

CUSTOM DESIGNED GATES.

Due to the wide-array of sizes available, our in-stock sliding and hinged gates work for nearly every pallet rack application. When your project calls for a special size, we offer custom design and manufacturing.

RACK ENCLOSURES SECURE INVENTORY

A Rack Back enclosure will control access to, and help prevent theft of, your high valued inventory items. A complete enclosure consists of panels on the back, ends, and top of the rack, with access gates on the front. Different configurations may be installed according to your specific needs.



Gates

PALLET RACK SLIDING GATES

- Ideally suited for multi-bay application.
- Our unique "double track" system keeps doors out of your way, and aisles clear of obstruction.
- Full height doors available up to 20-foot tall.
- Locking options available for added security.

PALLET RACK DOUBLE-HINGED GATES

- Ideally suited for single bay applications.
- Mount directly to the rack uprights.
- Full height doors available up to 20-foot tall.
- Locking options available for added security.

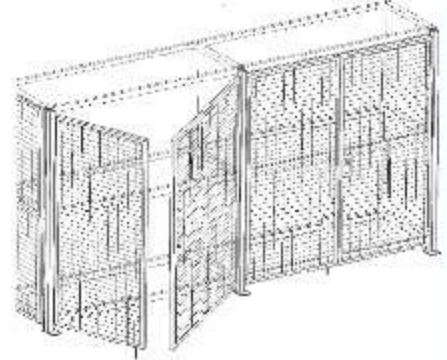
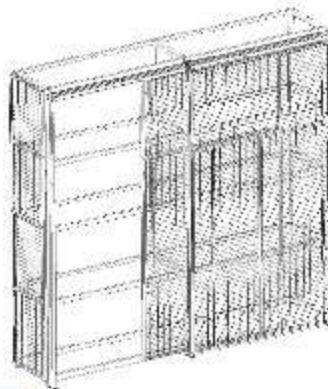

Physical Barriers

Adds Safety to the Workplace

STANDARD 5' HIGH PANELS

Part No.	Width	Weight
105	10'	74
95	9'	69
85	8'	63
75	7'	54
65	6'	48
55	5'	42
45	4'	36
35	3'	27
25	2'	22
15	1'	16

The sizes listed are stock items. Custom sizes available.

POSTS

Part No.	Height	Sweep Space
RP6	6'-2"	1'-0"
CP6	6'-2"	1'-0"

GATES

Part No.	Opening Width	Type
HD3	3'-0" x 5'-0"	Hinged
HD4	4'-0" x 5'-0"	Hinged

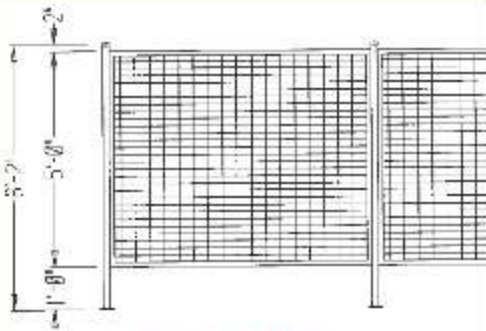

TYPICAL ELEVATION

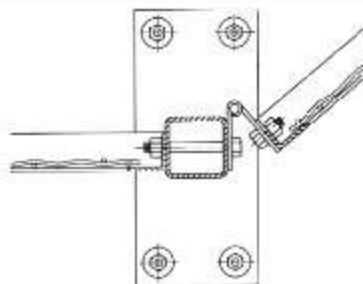

TOP VIEW OF ADJUSTABLE MOUNTING

Physical Barriers



PHYSICAL BARRIER



BARRIER WITH WELD CURTAINS



DIAMOND STYLE BARRIER

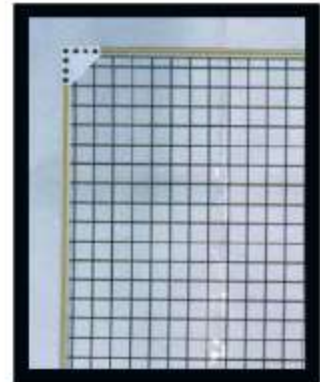

ALUMINUM EXTRUDED FRAMES

PHYSICAL BARRIERS

Woven wire panels provide a simple but effective way to protect personnel from the dangers of automated equipment. The versatility our Style 840 System allows us to meet many different customer demands while using standard product. Various heights, sweep spaces, lift out sections, non-right angle corners, heavy mesh, lexan panels, sheet metal panels, are all easily accomplished with our basic design. Some examples of our barriers are pictured above. Call us with your requirements.

OPTIONS

- Weld curtains
- Diamond Style Barrier
- Aluminum Extruded Frame Barriers

COLORS

The Physical Barrier may be ordered in any color. Our standard color is gray. The combinations of yellow, or yellow and black shown are options.

Alternate Materials

Choose from Special Meshes, Sheet Metal and Lexan

Other materials can be used when our standard 2" x 1" opening mesh does not meet your needs. WireCrafters stocks several different sized meshes, sheet metal, lexan, expanded metal, and welded wire for these special applications. Several of

the more popular items are pictured below. Our large inventory and modern manufacturing techniques allow us to make fast delivery of custom product, giving you an edge on the competition.

WireCrafters can upgrade the panel frames to larger angle, and increase the tubing size of the posts to meet your exact requirements. We are experienced with these special projects and welcome them.

special mesh



1/2" center-to-center square
12 gauge (3/8" square opening)
Uses: Any application which requires control over small items.

- Machine guards
- Small liquor bottles
- Federal Reserve
- Drug control

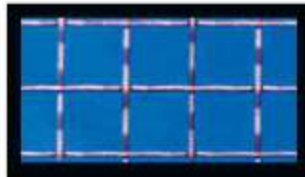

1-5/8" center-to-center square
8 gauge (1-1/2" square opening)
Uses: Galvanized partitions
This heavy mesh eliminates warping which may occur during the hot dip galvanize process.
Also used when our standard 2" x 1" 10 gauge is not strong enough.



2-1/4" center-to-center square
6 gauge (2" square opening)
Uses: Heavy duty construction

- Government facility import areas
- Police holding cells
- Prison lockup areas



2" center-to-center square
8 gauge welded wire mesh
(1-7/8" square opening)

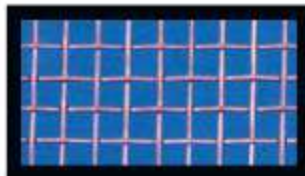

3/4" center-to-center square
10 gauge (5/8" square opening)



1-1/2" diamond mesh
10 gauge

sheet metal, lexan® and expanded metal



16-GAUGE SHEET METAL



EXPANDED METAL



LEXAN® CLEAR VIEW PANELS

Also available

Unique Woven Wire Applications



MEZZARAILSM

WireCrafters combined the strength of square handrail with the versatility of woven wire partition to create a unique handrail for mezzanines. MezzaRail, designed to replace multiple rail systems, outperforms them too. With its built-in kick plate and top rail,

MezzaRail sets up quicker – just two bolts per section – and acts as a barrier. Objects that pass through a multi-rail system are restrained by MezzaRail. Meets BOCA and OSHA codes for handrails. *For more information request our Protective Railing brochure.*



DEA APPROVED ENCLOSURES

When properly installed, WireCrafters Style 840 Partitions meet or exceed the requirements for storage of Class III, IV and V controlled substances as outlined in Section 1301.72 of the Code. For these applications the enclosure must be totally secure, gaps

between the partition and building structure may not exist. Doors must be self-closing and self-locking; all hardware must be brazed, pinned or tack welded in place. *For more information visit www.wirecrafters.com*

Storage Lockers/Guard Rails

OPEN MESH LOCKERS



SHEET METAL LOCKERS



STORAGE LOCKERS

WireCrafters' Woven Wire Storage Lockers are ideal for small enclosures. The units may be used individually or as a group. Two styles of lockers, single and double-tiered, are available in a variety of widths

and depths. Doors are prehung in angle frames which connect directly to wall panels. Two-sided units fit in the corner of existing rooms. Free standing units may be installed anywhere. *For more information ask for our Locker Brochure.*



GUARD RAILS

When Safety and Protection Matter...

- Constructed from heavy-duty 11-gauge formed steel.
- Mounting columns are available in two styles – single rail (17" height) or double rail (43" height).
- Lift-out rails allow easy access to protected areas.

- Base plates, for mounting to floor, are 10" square and come with four 7/8" holes for floor anchors (included).
- Rails are available in 2', 4', 6', 8', and 10' lengths.
- Competitively priced.
- *For more information request our Protective Railing brochure.*

Worksheet

Photocopy & Fax to 502-361-3857

Name
Company
Address
City/State/Zip
Fax #
Phone #
Zip Code of Ship-To Destination

Height: Standard 8' 5-1/4"
 Standard 10' 5-1/4"
 Standard 12' 5-1/4"
 Other _____ (please specify)

Color: Standard Gray
 Other _____ (please specify)

Ceiling: Yes No

Locks: Padlock Lugs Only
 Cylinder Lock Keyed Alike Different
 Special Lock Device _____ (please specify)

TO RECEIVE A PRICE ON WIRECRAFTERS PRODUCTS

- Photocopy this page, or go to www.wirecrafters.com/pricing.htm to download.
- Complete the information to the left.
- Sketch your layout below, note overall dimensions.
- Mark the location, size, and type of all doors and windows.
- Note construction type of adjacent walls and floor.
- Fax to WireCrafters at 502-361-3857.
- We will respond within one working day.

Style 840 Specs

Panels, Posts, Doors, Hardware & Finishes

WireCrafters®

Standard Color



Gray

Optional Colors



Black



Red



Blue



Safety Yellow



Orange



White



Tan

specs

PANELS

Panels are constructed of 10 gauge steel wire, woven into 2" x 1" rectangular mesh and securely welded to a 1-1/4" x 1-1/4" x 1/8" steel angle frame. Frames have 7/8" x 7/16" slotted holes for mounting to posts and adjacent panels. Panels four to seven feet wide have one 1/4" x 3/4" stiffener welded to the frame. Wider panels have two stiffeners.

POSTS

Posts are made of 2" x 2" x 14 gauge (.083) steel tubing. Base plates of 2" x 7" x 1/4" steel flat with two 7/16" round holes for floor anchoring, are welded to each. Top of post is finished with decorative cap. Posts are drilled with 1/2" holes to accept hardware for mounting panels and doors. Hole spacing is set to leave a 3-1/4" sweep space below the panels. Posts have a 2" projection above the panels.

PLEASE NOTE...

Representation of color is as close as printing techniques allow. Actual color may vary slightly.

DOORS

Doors are constructed of 10 gauge steel wire, woven into 2" x 1" rectangular mesh and securely welded 1-1/4" x 1-1/4" x 1/8" steel angle frame. Stiffeners, two horizontal and one vertical, of 1/4" x 3/4" steel flat are securely welded to the frame behind the mesh. Two gate posts, hardware, and padlock lugs are supplied with each door. Cylinder locks are available.

HARDWARE

All erection hardware is supplied. Panel mounting hardware is 3/8" standard thread grade two plated fasteners. Floor anchors are 3/8" wedge type.

FINISH

Standard finish for non-plated parts is one coat of gray acrylic enamel. Standard Gray Color, Optional In-Stock Colors and Custom Matched Colors are available in polyester-epoxy hybrid powder coat and traditional liquid acrylic enamel finish. Unless otherwise specified all pricing is based on standard gray liquid coating.

WireCrafters

6208 Strawberry Lane
Louisville, KY 40214

800/626-1816
502/363-6691
502/361-3857 FAX
www.wirecrafters.com



WireCrafters®

RAILING SYSTEMS FOR ALL YOUR INDUSTRIAL NEEDS



GUARDRAIL

PROTECTIVE RAILINGS

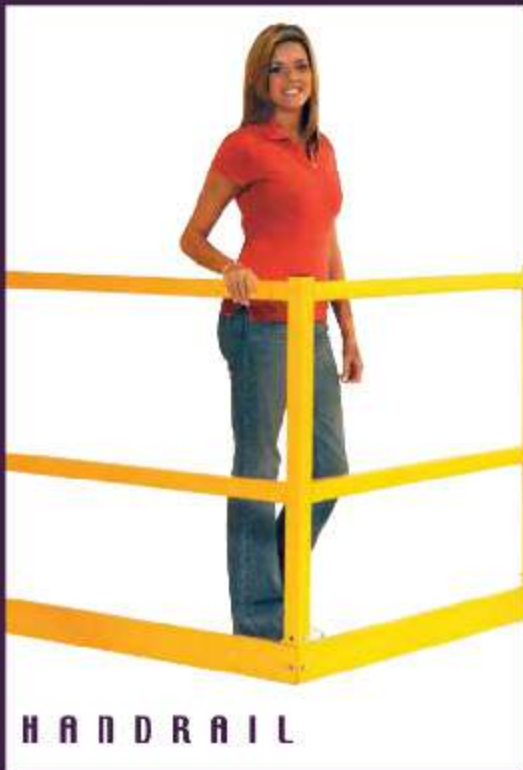

HANDRAIL

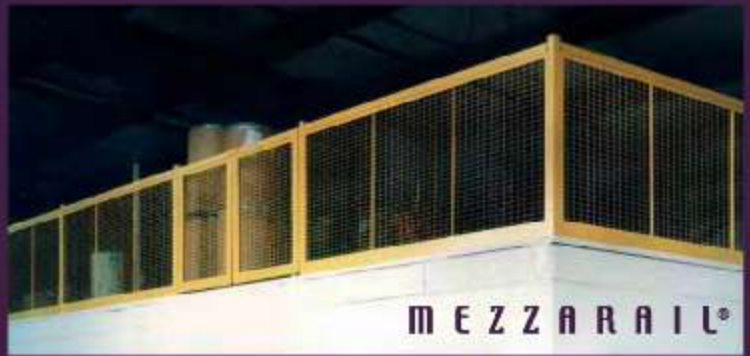

MEZZARAIL®



GuardRail

Perfect solution to in-plant traffic protection

GuardRail

Install WireCrafters GuardRail in your plant to protect people, machinery, and property from accidents involving forklifts, sweepers, or other moving equipment. This protective railing system helps prevent damage to equipment or facilities by providing a strong barrier along aisle ways or in front of critical equipment. Create a safety barrier with this competitively priced guard rail system, and save the expense of costly downtime repairs by preventing the accident with WireCrafters GuardRail.

STYLES AND SIZES – WireCrafters GuardRail comes in two styles, Single or Double Rail. Single Rail columns are 17" high, Double Rail columns are 43" high. All columns are 4" square x 1/4" wall structural-steel tubing, with metal caps, and 10" square x 1/2" thick steel base plates. Base plates have four 7/8" round anchor holes. Floor anchors provided.

RAIL LENGTHS – The 11-gauge formed steel rails come in six standard lengths, 2', 3', 4', 6', 8', and 10'. Custom lengths are available.

QUICK INSTALLATION – Bolt components together and anchor column base plates to the floor. All necessary hardware is included with your order.

OPTIONS – Rail Lift-Out kits, offset column base plates, and corner offset columns are available.



Standard Single High



Optional Lift-Out Rail



Standard Double High

Rail Parts

RAILS

Part No.	Description
PR 2	1'-8" Long
PR 3	2'-8" Long
PR 4	3'-8" Long
PR 6	5'-8" Long
PR 8	7'-8" Long
PR 10	9'-8" Long

COLUMNS

Part No.	Description
PRSRR	Single Run Post 17" High
PRSRC	Single Corner Post 17" High
PRDRR	Double Run Post 43" High
PRDRC	Double Corner Post 43" High

Railing Systems

Mezzanine Railing and Hand Railing Systems

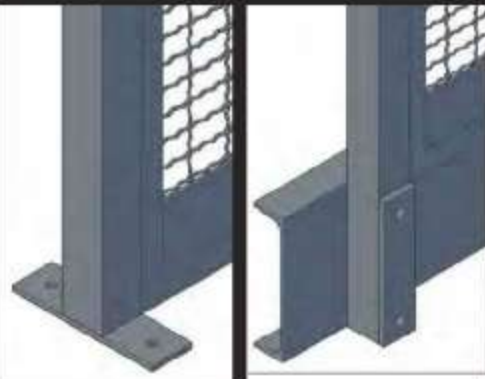

MezzaRail®

WireCrafters combined the strength of square handrails with the versatility of woven wire partitions to create the MezzaRail® 420 Rail System. This innovative handrail product provides more protection than 3, 4, or even 5 rail designs without the cost of additional rails or installation. Yet the system is so strong it meets the BOCA and OSHA requirements "of withstanding a load of 200 pounds applied in any direction at any point on the rail."

Better Protection

Not only does MezzaRail® provide you with a sturdy handrail, but the mesh component of each section acts as a barrier to prevent items from passing through to the ground below. Objects that easily pass through multi-rail systems are restrained by MezzaRail® protecting people and property from serious injury.

Easy Installation

Standard sized MezzaRail® panels, with built-in kickplates, bolt to upright posts. Two bolts per section. No welding, no self-tapping screws. All connecting hardware is easily accessible to the installer. The results are substantial cost savings to you in manpower, time, and equipment.



**CALL FOR LAYOUT ASSISTANCE,
PRICING, AND COMPARE COST ON
YOUR NEXT MEZZANINE RAIL PROJECT.**

HandRail

System 22 HandRail makes an excellent aisle way, machine guard rail, mezzanine rail or robot guard. This square steel rail system bolts up with standard hand tools.

System is designed on 8'-0" centers and comes in a standard two rail style. A 4" high kickplate can be added as an option. Rail sections combined with 6" run post

connectors or 4" corner/end posts to layout on 2', 4', or 8' centers. Stock rails can be field cut for custom lengths.

The top rail is 42" high with the mid-rail centered 20" from the floor. Rails and posts are constructed of 2" square, 14 gauge steel tubing. Posts have a 4" x 4" base plate with 7/16" diameter mounting holes. Anchors by others. System may be face mounted on mezzanines or deck mounted to the floor.



RAILS

Part No.	Description
HR 2	1'-6" Long
HR 4	3'-6" Long
HR 8	7'-6" Long

POSTS

Part No.	Description
HRRP	42" Run
HRCF	42" Corner
HREP	42" End

KICKPLATES

Part No.	Description
HRKP 2	2'-2" Long
HRKP 4	4'-2" Long
HRKP 8	8'-2" Long

Specifications

GuardRail, MezzaRail, and HandRail

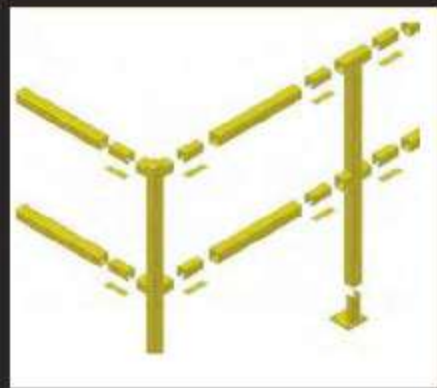
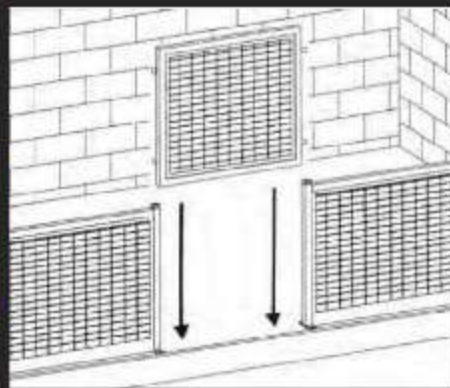

GuardRail

COLUMNS – All columns shall be made of 4" square x 1/4" wall structural steel tubing, with 10" square x 1/2" thick steel base plates securely welded to the column, and metal cap. Uprights shall have 9/16" holes drilled at the factory to accept rail mounting hardware. Single rail columns are 17" high, double rail columns 43" high. Column uprights shall be centered on base plates with four 7/8" holes for anchoring to the floor. Column uprights with offset base plates may have three holes for anchoring to the floor.

RAILS – All rails shall be formed from 11 gauge steel free from burrs and surface defects, with 3-1/2" x 13" x 1/4" steel end plates securely welded to each. Standard rail sections lengths are 1' 8", 2' 8", 3' 8", 5' 8", 7' 8" and 9' 8". Custom lengths available.

OPTIONS – Rail Lift Out kits, offset column base plates, and corner offset columns are available.

HARDWARE – Rails mount to columns with 1/2" x 5" through bolts. Columns anchor to floor with 3/4" x 4-1/4" wedge type anchors. Hardware provided.

FINISH – All non-plated parts receive two coats of yellow enamel.

MezzaRail®

PANELS – Constructed of 1-1/4" x 1-1/4" x 1/8" steel angle frame, with integrated 4" x 1-1/4" x 14 gauge kick plate across the bottom, and 2" x 1" opening 10 gauge woven wire mesh securely welded into frame. Standard panels are 42" high and 7'-10" long. Each panel has 2" square 14 gauge steel top rail welded to a framed wire mesh panel.

POSTS – Newel type posts made of 2" square 14 gauge steel tubing, with decorative steel cap welded into place. Deck mount posts have 3/8" x 2" x 7" base plates securely welded to each. Face mount posts utilize a 1/4" x 2" x 8" plate and bolt to mezzanine's structural edge. MezzaRail® panel section and post combine to make maximum 8' 0" post centers.

HARDWARE – Standard 3/8" grade 2 plated fasteners are supplied for connecting panels and posts. Floor or deck anchors are not provided.

FINISH – All non-plated parts receive two coats of yellow enamel.

INSTALLATION – Buyer should seek the technical assistance necessary to determine the proper anchorage/attachment technique required for each installation. Determination of the anchoring/attachment method used is solely at the buyer's discretion and should be determined with the special structural conditions of the project.

HandRail

POSTS AND RAILS – Constructed of 2" square 14 gauge steel tubing. Two formed 14 gauge steel inserts with 1/8" threaded flat bar shall be provided to connect each rail section to post. All parts factory drilled to accept 3/8" mounting hardware.

FLOOR SOCKETS – Consist of 4" x 4" x 1/4" base plate punched with four 7/16 round mounting holes, with a single formed 11 gauge steel mounting channel securely welded into place.

KICKPLATE – Shall be 4" in height, constructed of 16 gauge sheet steel, formed at ninety degrees along the top edge and punched with slotted holes on each end for mounting to upright posts. Ends of adjacent kickplates overlap where mounted to post.

FINISH – All non-plated parts receive two coats of yellow enamel.

WireCrafters

6208 Strawberry Lane
Louisville, KY 40214

800/626-1816
502/363-6691

502/361-3857 FAX
www.wirecrafters.com





Physical Barriers

Woven and Welded Wire Solutions.

PHYSICAL BARRIERS • MACHINE GUARDS • ROBOTIC WORK CELLS • PERIMETER OR AREA GUARDS

WireCrafters



THE ORIGINAL
STYLE 840
WOVEN WIRE
BARRIER



RAPID
WIRE HD
WELDED
WIRE
BARRIER



RAPID
GUARD
LIFT-OUT
GUARDING
SYSTEM



STYLE 304
STAINLESS
STEEL
PERIMETER
GUARD

WireCrafters®

The amazingly versatile physical barrier.

For over 45 years, WireCrafters has manufactured what we feel is the "Very Best Physical Barrier." Contrary to traditional systems, ours systems are framed on all four sides for durability and strength. This all-welded, modular system has benefits unequaled in the industry.

Look to us for these products:

- Physical Barriers
- Machine Guards
- Robotic Work Cells
- Perimeter or Area Guards
- Welding Workstation Enclosures
- Vertical Lift Enclosures
- Lift-Out Systems
- Food Processing Areas
- Drug Manufacturing Areas
- Automation Guards
- Conveyor Guards

Visit us online at www.wirecrafters.com

OPTION

1

Style 840

The Original Woven Wire Barrier.

48-HOUR QUICK SHIP

STANDARD 6'-2" GUARD SYSTEM

QUICK SHIPS!

Our barriers are a reliable, versatile, and economical answer to personnel safety...

Wire Partitions from WireCrafters® are a simple, effective way to protect personnel from the dangers posed by automated equipment. These barriers are a strong, reliable, and economical solution to plant safety needs. System versatility allows easy integration of access doors or material-handling openings with system controls. Unlike hi-tech devices, this guard is always on duty, unaffected by power outages or electrical problems. Also doubles as a potential safety net by containing objects ejected by a malfunctioning robot. Crimped and woven wire mesh is resilient; resists dings, retains its shape, and appearance.

Our basic physical barrier system combines a 5' high panel and 6'-2" high posts. Panels bolt to posts using standard 3/8" hardware. Configuration leaves 1' sweep space beneath panel and a 2" projection above panel. Each post has a 4" x 9" x 3/8" baseplate for mounting to the floor. Four 3/8" anchors included with each post. Enclosures with odd-angle perimeters can be created with adjustable mounting hardware. Three- and four-foot-wide hinged gates are available.

Quick Ship...

Our standard Guard Systems are available for 48-hour shipping. All Quick Ship items are only available in standard gray. Yellow or black panels and yellow posts ship in one week.



STANDARD 6'-2" GUARD SYSTEM 6'-2" POSTS, 5' HIGH PANELS, 1' SWEEP

PANELS

Part No.	Width x Height	Weight
105	10'-0" x 5'-0"	74
95	9'-0" x 5'-0"	68
85	8'-0" x 5'-0"	63
75	7'-0" x 5'-0"	54
65	6'-0" x 5'-0"	48
55	5'-0" x 5'-0"	42
45	4'-0" x 5'-0"	36
35	3'-0" x 5'-0"	27
25	2'-0" x 5'-0"	22
15	1'-0" x 5'-0"	16

POSTS

Part No.	Height	Sweep Space	Weight
RP6	6'-2"	1'-0"	18
CP6	6'-2"	1'-0"	18

DOORS

Part No.	Opening Width	Type	Weight
HDR356	3'-0" x 5'-0"	Hinged	81
HDR456	4'-0" x 5'-0"	Hinged	86

(Each door supplied with two door posts and door hardware. To specify lock or latching options, see page 9.)

Free design and layout assistance available. Call 800-626-1816.

ADJ MOUNTING BRACKET

Part No.	Width x Height	Weight
ADJPK	4" x 4"	1

See similar specs on page 3.

TOP VIEW OF ADJUSTABLE MOUNTING

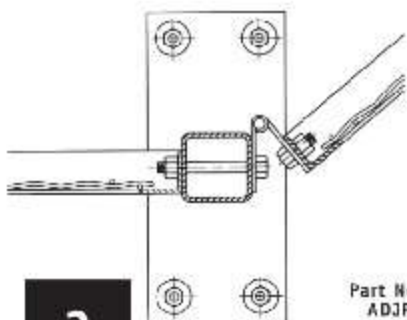

TYPICAL ELEVATION

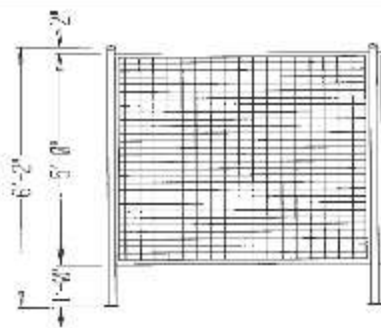

2

OPTION

1

Style 840

The Original Woven Wire Barrier.

48-HOUR
QUICK
SHIP

STANDARD 8'-5" GUARD SYSTEM

QUICK SHIPS!

WALL PANELS

- Ten widths, 1' to 10' in one-foot increments.
- Standard panel height is 4'-0".
- Full height partition walls are built by stacking two panels between posts.
- Mesh: 10-gauge wire woven into 2" x 1" rectangular openings.
- Frame 1-1/4" x 1-1/4" x 1/8" steel angle.
- Custom size panels available.
- Alternate meshes available, see page 4.

HINGED DOORS

- 3' or 4' wide by 7'-3 1/4" high opening.
- Transom panel sized to match partition height.
- Three 4" x 4" 10 gauge tight pin hinges.
- Padlock lugs standard, other locks available.
- Ships with two door posts and hardware.
- Universal construction, works for left or right hand, inside or outside swing.

DOUBLE-HINGED DOORS

- 6' or 8' wide by 7'-3 1/4" high opening.
- Inactive leaf secured by cane bolt (base) and chain bolt (top).
- Padlock lugs standard, other locks available.
- Ships with two door posts and hardware.
- Transom panel sized to match partition height.
- Custom size and no overhead obstruction doors available.

SLIDING DOORS

- 3', 4', 5', 6', 8' or 10' widths.
- Full height partition openings of 8'.
- Padlock lugs standard, other locks available.
- Ships with two door posts, two 4-wheel trolley trucks, 1/2-gauge track, and all hardware.
- Universal construction, works for left/right hand, inside/outside.
- Custom sizes available.

POSTS

- Stock size: 8'-5 1/4".
- Standard hole layout allows for 3 1/4" sweep space.
- Posts project 2" above top of panel.
- Standard Baseplate: 2" x 7" with holes for anchors.
- 3/8" Floor anchors are included with your order.

WARRANTY

Five (5) years. Consult specific limited warranty statement.

Never "too tall" of an order to fill!

For taller systems, use our standard 8'-5" physical barrier. This system utilizes two 4'-high panels stacked between 8'-5" posts. It features a 3-1/4" sweep space beneath the panels with a 2" post projection above the panels. Posts have a 2" x 7" x 1/4" baseplate for mounting to the floor (two 3/8" anchors included). System bolts together with standard 3/8" hardware. Full line of hinged and sliding doors are available. This physical barrier system is easy to reconfigure as needs change.

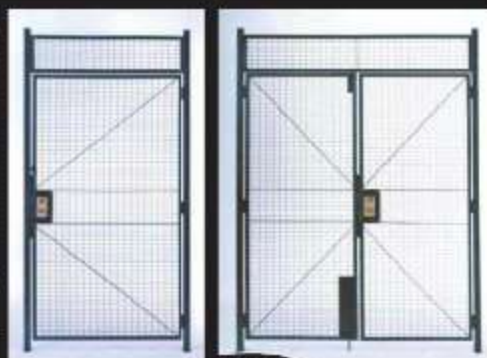
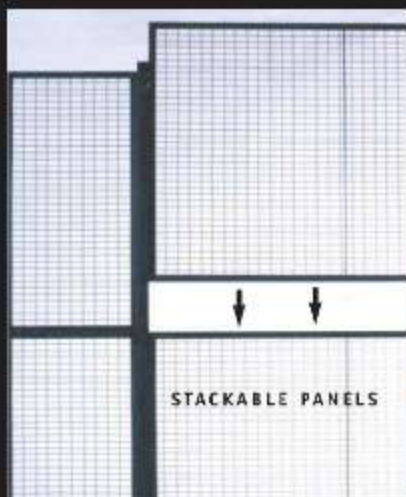

NOTE

STANDARD 10'-5" AND 12'-5" BARRIER SYSTEMS OF SIMILAR CONSTRUCTION ARE ALSO AVAILABLE.

STANDARD 8'-5" GUARD SYSTEM

PANELS

Part No.	Width x Height	Weight
104	10'-0" x 4'-0"	63
94	9'-0" x 4'-0"	58
84	8'-0" x 4'-0"	53
74	7'-0" x 4'-0"	46
64	6'-0" x 4'-0"	41
54	5'-0" x 4'-0"	36
44	4'-0" x 4'-0"	31
34	3'-0" x 4'-0"	23
24	2'-0" x 4'-0"	18
14	1'-0" x 4'-0"	13

HINGED DOORS

Part No.	Opening		Weight
	Width x Height		
HD-37-8	3'-0" x 7'-3 1/4"		106
HD-47-8	4'-0" x 7'-3 1/4"		118

DOUBLE-HINGED DOORS

Part No.	Opening		Weight
	Width x Height		
DHD67-8	6'-0" x 7'-3 1/4"		170
DHD87-8	8'-0" x 7'-3 1/4"		193

SLIDING DOORS

Part No.	Width x Height	Weight
SD-38-8	3'-0" x 8'-0 1/4"	124
SD-48-8	4'-0" x 8'-0 1/4"	137
SD-58-8	5'-0" x 8'-0 1/4"	149
SD-68-8	6'-0" x 8'-0 1/4"	196
SD-88-8	8'-0" x 8'-0 1/4"	230
SD-108-8	10'-0" x 8'-0 1/4"	279

STOCK SIZE POST

Part No.	Height	Weight
RP-8		
Run	8'-5 1/4"	20
CP-8/TP-8		
Corner/TEE	8'-5 1/4"	21

COMPLIES WITH
OSHA AND ANSI/RIA
SAFETY STANDARDS FOR
MACHINE TERRITORY
EDUCATION

3

OPTION

1

Style 840

The Original Woven Wire Barrier.

CUSTOM OPTIONS

DESIGN THE PERFECT BARRIER

CUSTOM COLORS, ACCESSORIES AND MORE



POWDER COAT YELLOW PANELS AND POSTS

SPECIAL COLORS

As an option, you may request your barriers to be all yellow or black panels and doors with yellow posts. We can also match RAL numbers and can provide your barriers with many different finishes. Most special colors are powder-coated.

ACCESS PANELS

System offers Lift Out Panels for frequently accessed areas and Removable Panels for entry points that require more control. These panels may be combined with standard panels and posts at any location in the system.

HEIGHT

WireCrafters' physical barriers are not limited to the standard heights detailed on pages 2 and 3. We can supply physical barriers to any height you may require.

WELDING CURTAINS

Welding curtains, sized to match panel dimensions, are available in a variety of colors. Curtains protect personnel from welding flash and sparks.

MOUNTING PLATES FOR INTERLOCKS AVAILABLE

Should you prefer to use an interlocking system, WireCrafters' can provide the mounting plates on the doors and posts for these devices.

PANEL MATERIALS

Non-standard size panels, panels with cutouts or pass-thru openings can be integrated into your system. Call and ask for details on these special items. (See the lift-out and removable panel styles in the Rapid Guard Section)



CUSTOM WELDING CURTAINS

UNOBSTRUCTED TUNNEL GATES

Tunnel Gates have unobstructed openings. Leading edge of door rolls on floor casters. Locking or latching options available and plates for mounting safety interlock switches.

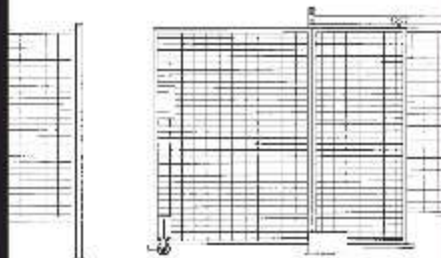

SPECIAL SIZE WOVEN WIRE MESH

1/2" center-to-center square
12 gauge (3/8" square opening)

1-5/8" center-to-center square
8 gauge (1-1/2" square opening)

2-1/4" center-to-center square
6 gauge (2" square opening)

3/4" center-to-center square
10 gauge (5/8" square opening)

Sheet Metal
16 gauge

Polycarbonate
1/4"

OPTION **2**

Rapid Wire HD

Welded Wire Barrier.

Introducing RapidWire™ Machine Perimeter Guarding

The RapidWire® system utilizes a modular design which allows for combinations of standard parts to meet your specific requirements. The system's three basic components—framed panels, posts, and a wide variety of door styles—provide the flexibility to design and install any type of machine perimeter guarding required to make your robotic cell safe to use. WireCrafters can tailor-make a system that meets your rigorous safety standards.

VERSATILE: RapidWire's welded wire panels have superior strength because the panel's wires are welded at each intersection, then framed on all four sides with 1 1/4" x 1 1/4" x 13 gauge roll-formed angle. Although strong, every RapidWire® panel can be field modified to fit exacting dimensional limitations making unforeseen adjustments easy to accomplish and look professionally finished. RapidWire's superior design allows for easy relocation of the system should your needs change.

VISUAL APPEAL: Welded wire's straight lines and inherent strength provide a strong, modern looking guard to complement your facility and equipment.

SECURITY: By the nature of its welded wire design, RapidWire™ machine guarding system provides an unparalleled level of security. Strong 2" x 2" x 14 gauge tube posts reinforce the system. Panels are constructed of 8 and 10 gauge wire welded into a pattern of 1 1/4" x 3". For added structural integrity, each panel has a 13 gauge angle welded along its length. System heights of 6' and 8' are available as standard.

FAST INSTALLATION: RapidWire, with its modular design, can be installed in 20% to 25% less time when compared to competing products.



COMPLIES WITH
OSHA AND ANSI/RIA
SAFETY STANDARDS FOR
MACHINE PERIMETER
GUARDING.

RAPID WIRE HD ENCLOSURE IN ACTION



STACKABLE PANELS WITH 1/8" CLEAR POLY-CARBONATE TOP AND RAPID WIRE HD PANEL ON THE BOTTOM

OPTIONAL FORTRESS® INTERLOCKS

5

Machine Perimeter Guarding Specs

FINISH: Powder Coated Finish.

PANELS: 8 and 10 gauge wires are welded at each intersection to provide mesh patterns of 1 1/4" x 3", 5/8" x 3" or 2" x 2". Each panel is finished with two 1 1/4" x 1 1/4" x 13 gauge roll-formed angles welded along its length. This unique design allows for the stacking of panels to the desired structure's height. Panels are completely framed in place when connected to posts.

POSTS: 2" x 2" x 14 gauge tubing is furnished with a 2" x 7" x 1/4" base plate welded at its end. Standard heights of 6' and 8' are inventoried. Other heights available.

DOORS-HINGED: Welded wire mesh consistent with the panel mesh is utilized in the door's design. Doors can be hinged either right or left with both swings of in or out. Clear height of all doors is 2" less than that of the system's height. Doors are framed in 1 1/4" x 1 1/4" x 13 gauge angle.

DOORS-SLIDING: Welded wire mesh consistent with the panel mesh is utilized to manufacture sliding doors. Single sliding doors are furnished with the patented tamper-resistant sliding door receiver. Paired sliding doors also available. All sliding doors are framed in 1 1/4" x 1 1/4" x 13 gauge angle.

DOORS-TUNNEL: Welded wire mesh consistent with the panel mesh is utilized to manufacture Tunnel Doors. Tunnel Doors provide clear overhead access to secure areas by supporting door's leading edge with floor casters and the rear of the door supported by sliding door track mounted to the system's posts. All Tunnel Doors are framed in 1 1/4" x 1 1/4" x 13 gauge angle.

DOOR LOCKS: All doors are furnished with a padlock lug; standard built-in cylinder locks are available. Available as options are various lever/knob styles, coded entry/ push lever, panic bars, coded card readers, numerical key pads, magnetic style locks and electric strikes. Also available as an option are keyed-alike locks, master-keyed locks, Best® cylinders (less core) and any 1" mortised cylinder.

OPTIONS: Additional items to supplement and complete your Physical Barrier system are available from WireCrafters®. They include: Interlocks and the mounting of this product to ensure ease of installation and operation. Weld curtains, manufactured per system requirements, to shield employees from harmful welding flash.

HARDWARE: All hardware needed for installation, including floor anchors, is furnished as standard.

WARRANTY: Five (5) years. Consult specific limited warranty statement.

STANDARD 6'-2" GUARD SYSTEM

PANELS

Part No.	Width x Height	Weight
105	10'-0" x 5'-0"	74
95	9'-0" x 5'-0"	68
85	8'-0" x 5'-0"	63
75	7'-0" x 5'-0"	54
65	6'-0" x 5'-0"	48
55	5'-0" x 5'-0"	42
45	4'-0" x 5'-0"	36
35	3'-0" x 5'-0"	27
25	2'-0" x 5'-0"	22
15	1'-0" x 5'-0"	16

POSTS

Part No.	Height	Sweep Space	Weight
RP6	6'-2"	1'-0"	18
CP6	6'-2"	1'-0"	18

DOORS

Part No.	Opening Width	Type	Weight
HDR356	3'-0" x 5'-0"	Hinged	81
HDR456	4'-0" x 5'-0"	Hinged	86

(Each door supplied with two door posts and door hardware. To specify lock or latching options, see page 9.)

Free design and layout assistance available. Call 800-526-1816.

STANDARD 8'-5" GUARD SYSTEM

PANELS

Part No.	Width x Height	Weight
104	10'-0" x 4'-0"	63
94	9'-0" x 4'-0"	58
84	8'-0" x 4'-0"	53
74	7'-0" x 4'-0"	46
64	6'-0" x 4'-0"	41
54	5'-0" x 4'-0"	36
44	4'-0" x 4'-0"	31
34	3'-0" x 4'-0"	23
24	2'-0" x 4'-0"	18
14	1'-0" x 4'-0"	13

HINGED DOORS

Part No.	Opening		Weight
	Width	Height	
HD-37-8	3'-0"	7'-3 1/4"	106
HD-47-8	4'-0"	7'-3 1/4"	118

DOUBLE-HINGED DOORS

Part No.	Opening		Weight
	Width	Height	
DHD67-8	6'-0"	7'-3 1/4"	170
DHD87-8	8'-0"	7'-3 1/4"	193

SLIDING DOORS

Part No.	Width x Height	Weight
SD-38-8	3'-0" x 8'-0 1/4"	124
SD-48-8	4'-0" x 8'-0 1/4"	137
SD-58-8	5'-0" x 8'-0 1/4"	149
SD-68-8	6'-0" x 8'-0 1/4"	196
SD-88-8	8'-0" x 8'-0 1/4"	230
SD-108-8	10'-0" x 8'-0 1/4"	279

STOCK SIZE POST

Part No.	Height	Weight
RP-8		
Run	8'-5 1/4"	20
CP-8/TP-8		
Corner/Tee	8'-5 1/4"	21

OPTION **3**

RapidGuard

The Lift-Out Guard System.

The All-New Lift Out Guarding System that Installs Fast and Costs Less!

- Lift-out panels install 50% faster than conventional physical barrier products.
- Standard mesh is 1 1/4" x 3", 10-gauge wire welded on 8-gauge vertical wire. Alternate meshes available depending on your guarding requirements.
- Available in standard 6' and 8' panel heights.
- Frames are 1 1/4" x 1 1/4" x 13 gauge angle frame.
- Available with hinged or sliding doors.
- Available with tool-removable panels from inside for OSHA compliance when necessary.
- Powder Coat Finish; black panels, yellow posts.
- Five (5) year warranty. Consult specific limited warranty statement.

48-HOUR QUICK SHIP



COMPLIES WITH
OSHA AND ANSI/RIA
SAFETY STANDARDS FOR
MACHINE PERIMETER
GUARDING.



SLIDING DOOR AND INTERLOCK



OSHA-COMPLIANT TOOL REMOVABLE BOLTS ARE ACCESSIBLE FROM INSIDE THE ENCLOSURE

DROP-IN MOUNTING BRACKET

7

OPTION 3

RapidGuard

The Lift-Out Guard System.

48-HOUR
QUICK
SHIP

LIFT-OUT PANELS, POSTS AND DOORS

Powder Coat Finish; black
panels, yellow posts

LIFT-OUT PANELS

WIDTH	HEIGHT
0'-6"	6'-2 13/16"
1'-0"	6'-2 13/16"
2'-0"	6'-2 13/16"
3'-0"	6'-2 13/16"
4'-0"	6'-2 13/16"
5'-0"	6'-2 13/16"
0'-6"	8'-1 1/4"
1'-0"	8'-1 1/4"
2'-0"	8'-1 1/4"
3'-0"	8'-1 1/4"
4'-0"	8'-1 1/4"
5'-0"	8'-1 1/4"

RUN POSTS

WIDTH	HEIGHT
2"	6'-6 3/4"
2"	8'-5 1/4"

CORNER POSTS

WIDTH	HEIGHT
2"	6'-6 3/4"
2"	8'-5 1/4"

SLIDING DOORS

WIDTH	HEIGHT
3'-0"	6'-2 13/16"
4'-0"	6'-2 13/16"
5'-0"	6'-2 13/16"
6'-0"	6'-2 13/16"
3'-0"	8'-1 1/4"
4'-0"	8'-1 1/4"
5'-0"	8'-1 1/4"
6'-0"	8'-1 1/4"

HINGED DOORS

WIDTH	HEIGHT
3'-0"	6'-2 13/16"
4'-0"	6'-2 13/16"
3'-0"	8'-1 1/4"
4'-0"	8'-1 1/4"



EASY-GLIDE TRACK SYSTEM ALLOWS DOORS TO OPEN AND CLOSE SMOOTHLY.

OPTIONAL EXTERIOR
NON-LOCKING
THUMB
TURN LATCH
(SF-2)



OPTIONAL INTERIOR
NON-LOCKING
THUMB
TURN LATCH
(SB-1)



OPTIONAL
FORTRESS®
INTERLOCKS



DESIGN FLEXIBILITY

- Door Interlocks
- Polycarbonate Panels
- Solid Steel Panels
- Weld Curtain Panels

OPTION 4

Style 304

Stainless Steel Perimeter Guard.

INTRODUCING STYLE 304 STAINLESS STEEL PERIMETER GUARD

Our new 304 Stainless Steel Partition System is ideal for food processing and drug manufacturing facilities. The open but secure design allows you to have safety and security with the ability to wash down this corrosion-resistant partition system.

- Open design allows for spray down with no accumulating water.
- Ideal for food processing plants and drug manufacturing facilities.
- Stainless finish, corrosion resistant

Note: All material Type 304 Stainless Steel No. 2B Finish Panels installed vertically between uprights



EASY-GLIDE TRACK SYSTEM ALLOWS DOORS TO OPEN AND CLOSE SMOOTHLY.



STYLE 304 STAINLESS STEEL PERIMETER GUARD SPECIFICATIONS

MESH

- Thickness: 10ga (.135)
- Design: 1 1/2 x 1 1/2 (Center to Center) Square Welded Wire (1 3/8" Square Opening)

PANELS

- Frame: 1 1/4" x 1 1/4" x 1/8" Angle
- Fabrication: Mesh is securely welded to angle frame
- Stiffeners welded to frame behind mesh panels.

DOOR

- Frame: 1 1/4" x 1 1/4" x 1/8" Angle
- Fabrication: Mesh is securely welded to angle frame
- Stiffeners welded to frame for extra strength

POST

- Material: 2 x 2 x 2 11ga Formed Channel
- Fabrication: 1/4 x 4 x 9 Plate welded at base of post

HARDWARE

- Shall be 3/8" standard thread stainless steel for panel and door connections
- 3/8" floor anchors and all other hardware furnished with each job

FINISH

- 1 stage glass bead blast on all parts
- Stainless Steel

WARRANTY

Five (5) years. Consult specific limited warranty statement.

Standard Locks

Standard Fronts and Backs Ship Within 48 Hours.

STANDARD FRONT (SF-1)



ALTERNATE FRONTS



(SF-2) Thumb-Turn Latch... latches only, does not lock.



(SF-3) Door Knob Entry... latches only, does not lock.

ALTERNATE FRONTS work with any of the three backs shown below.

ALTERNATE BACKS work with any of the locks shown to the left.

STANDARD BACK (SB-1)



ALTERNATE BACKS



(SB-2) Interior Key... lock from both sides, keyed to match face side.



(SB-3) Door Knob... typical size door knob for easy exit.



(SB-4) Lever Handle... alternative to standard door knob. Meets ADA requirements.

keying options

STANDARD CYLINDERS:

- Standard locks are supplied keyed different.
- Keyed alike locks available
- Optional Master Key available

ALTERNATE CYLINDERS:

- Best Cylinder® Less Core
- Any 1" mortise cylinder



We offer both **Euchner and Fortress Interlock Systems.**



Euchner Interlock Systems



Fortress Interlock Systems

Put our "Lock Experience" to the Test!

Let us know if you need a special locking device. We have experience with many different lock styles. Let us put our know-how to work for you.

Worksheet

Photocopy & Fax to 502-361-3857

CHECK ONE

- OPTION ONE: Style 840 Barriers (Woven Wire)
- OPTION TWO: Rapid Wire HD (Welded Wire)
- OPTION THREE: Rapid Guard (Lift-Out Panels)
- OPTION FOUR: Style 304 Barriers (Stainless Steel)

Name _____	
Company _____	
Address _____	
City/State/Zip _____	*Skip-To* Zip Code _____
Fax # _____	
Phone # _____	

HEIGHT:

- Standard 6'-2" (includes 1" sweep space and 2" post projection)
- Standard 8' 5 1/4" (includes 3 1/4" sweep space and 2" post projection)
- Other _____

COLOR:

- Standard Gray Black Panels/Yellow Posts
- All Yellow Other _____

LOCKS:

- Cylinder Lock Keyed Alike Different
- Latch Only/Turn Knobs, Both Sides
- Other _____

TO RECEIVE A PRICE ON WIRECRAFTERS PRODUCTS:

- Photocopy this page or go to www.wirecrafters.com and click on "RFQ".
- Complete the information to the left.
- Sketch your layout below, note overall dimensions.
- Mark the location, size, and type of all doors and windows.
- Note construction type of adjacent walls and floor.
- Fax to WireCrafters at 502-361-3857.
- We will respond within one working day.

6208 Strawberry Lane
Louisville, KY 40214
800-626-1816
www.wirecrafters.com

WireCrafters

WireCrafters

Military Storage

Ready to Serve

All-Purpose Cages

Modular Design Twenty basic panels and our "building block" approach accomplish virtually any layout.

Strong Panels bolt directly to support posts. Standard 3/8" wedge anchors hold partition firmly in place. Base plates welded on posts allow direct floor anchoring.

Secure Utilizes heavy assembly hardware. Bolts are only accessible from inside.

Fast Installation Fewer parts and angle frames give clear access to all mounting hardware and make for a quick install.



STANDARD 840 CAGE SPECIFICATIONS

PANELS

Panels are constructed of 10 gauge steel wire, woven into 2" x 1" rectangular mesh and securely welded to a 1-1/4" x 1-1/4" x 1/8" steel angle frame. Frames have 7/8" x 7/16" slotted holes for mounting to posts and adjacent panels. Panels four to seven feet wide have one 1/4" x 3/4" stiffener welded to the frame. Wider panels have two stiffeners.

POSTS

Posts are made of 2" x 2" x 14 gauge (.083) steel tubing. Base plates of 2" x 7" x 1/4" steel flat with two 7/16" round holes for

floor anchoring, are welded to each. Top of post is finished with decorative cap. Posts are drilled with 1/2" holes to accept hardware for mounting panels and doors. Hole spacing is set to leave a 3-1/4" sweep space below the panels. Posts have a 2" projection above the panels.

DOORS

Doors are constructed of 10 gauge steel wire, woven into 2" x 1" rectangular mesh and securely welded 1-1/4" x 1-1/4" x 1/8" steel angle frame. Stiffeners, two horizontal and one vertical, of 1/4" x 3/4" steel flat are securely welded to the frame behind the mesh. Two gate posts, hardware, and padlock lugs are supplied with each door. Cylinder locks are available.

HARDWARE

All erection hardware is supplied. Panel mounting hardware is 3/8" standard thread grade two plated fasteners. Floor anchors are 3/8" wedge type.

FINISH

Standard finish for non-plated parts is one coat of gray acrylic enamel. Standard Gray Color, Optional In-Stock Colors and Custom Matched Colors are available in polyester-epoxy hybrid powder coat and traditional liquid acrylic enamel finish. Unless otherwise specified all pricing is based on standard gray liquid coating.

OPTIONS

- 6-gauge, 2"-square, woven wire mesh
- 1/4" Tamper-Resistant Hardware

800-626-1816
or visit us on-line
www.wirecrafters.com

WireCrafters

WireCrafters

Military Storage

Ready to Serve

TA-50 Military Lockers

In conjunction with the United States Military, WireCrafters has furnished many different designs of TA-50 lockers. All-welded construction with either sliding or hinged lockable doors and either woven/welded wire mesh or expanded metal provides the type of unit that will give the functional storage demanded by our military personnel. The units are ideal for storage of specialized tactical gear or standard issue items. Lockers may be ordered completely set up ready for placement, or knocked down ready to assemble. Let WireCrafters work with your personnel in designing and providing the very best TA-50 locker.



TA-50 STORAGE LOCKER SPECIFICATIONS

All-Welded Construction or Knock Down Ready-to-Assemble.

MESH:

2" sq.-10 gauge welded wire welded to steel angle frame.

FRAMES:

• Side Panels: 1 1/4" x 1 1/4" x 13-gauge steel angle frames with 2" sq.-10 gauge welded wire welded to frame.

- Door: 1 1/4" x 1 1/4" x 13-gauge steel angle frames with 2" sq.-10 gauge welded wire welded to frame. Pre-hung to 1 1/4" x 1 1/4" x 13-gauge vertical angle jambs with 2 1/2" x 2 1/2" spun hinges. All doors have padlock/lug attachment.
- Top Panel: 2" sq.-10 gauge welded wire.
- Back: #16 gauge galvanize sheet metal.
- Coat Rod: 1/2" schedule 40 galvanize pipe.
- Shelf: 2 - #16 gauge galvanized sheet metal. Each shelf section is 1" deep, bolted to 1 1/4" angle support.
- Coat Hooks: Three side hooks securely attached to the bottom side of the shelf.

FINISH:

WireCrafters powder coat gray paint. Galvanized and plated parts are shipped as is. Custom colors are available.

HARDWARE:

All interconnection hardware is furnished in zinc plated finish. Wall and floor anchors optional.

OPTIONS:

- One aluminum number plate per locker
- Three-point locks
- 16-gauge formed bottoms
- 13-gauge expanded metal
- Multiple mesh sizes

800-626-1816
or visit us on-line
www.wirecrafters.com

WireCrafters

RapidWire™

RackBack®

A Welded Wire Solution.

IMPROVE WAREHOUSE SAFETY

Contain falling items with RapidWire RackBack® panels from WireCrafters. Modular sized panels mount directly to pallet rack system. Installs quickly and provides safety. System is made of 2" x 2" x 10 gauge steel welded wire mesh, welded into a 1-1/4" x 1-1/4" x 13 gauge steel angle frame. Panels have mounting holes on six inch centers and are provided with flush mount or offset brackets to allow for pallets that overhang the beams. *Above the Top* kit allows panels to extend above the top rack beam to contain loads stored there. Custom sizes available.

STOCK PANEL SIZES

Part Number	Width x Height	Weight (lbs.)
-------------	----------------	---------------

Four Foot High Panels

BACK124	12' 0" x 4' 0"	74
BACK104	10' 0" x 4' 0"	47
BACK94	9' 0" x 4' 0"	44
BACK84	8' 0" x 4' 0"	40
BACK74	7' 0" x 4' 0"	34

Five Foot High Panels

BACK125	12' 0" x 5' 0"	84
BACK105	10' 0" x 5' 0"	55
BACK95	9' 0" x 5' 0"	51
BACK85	8' 0" x 5' 0"	46
BACK75	7' 0" x 5' 0"	39

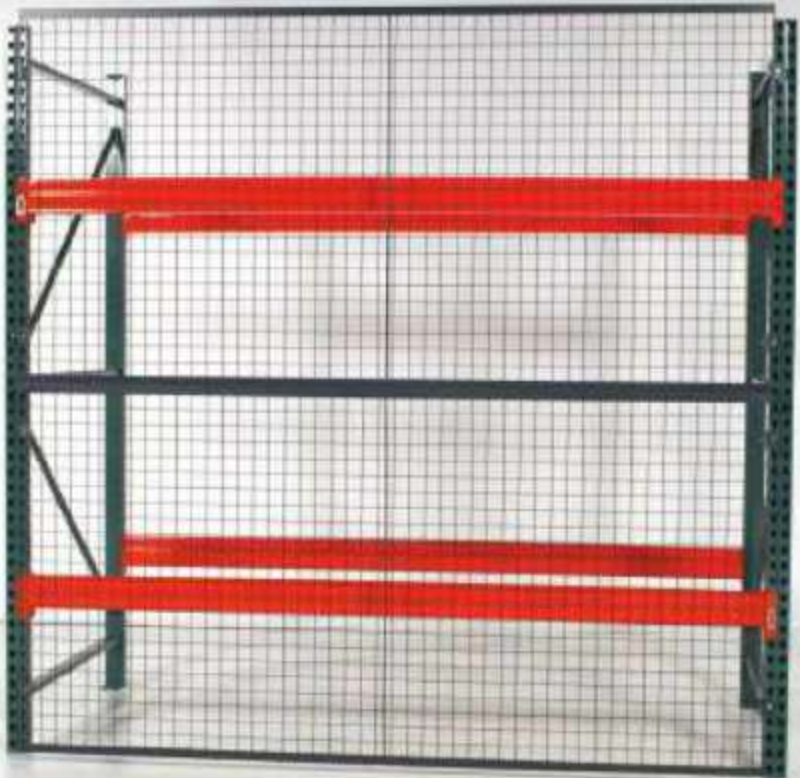

WireCrafters RapidWire RackBack Pallet Backing



Mounting brackets allow for pallet over-hang



Panels extend above top beam for complete protection



Hinged doors for rack enclosure

6208 Strawberry Lane
Louisville, KY 40214
800-626-1816
www.wirecrafters.com



WireCrafters®

RapidWire™

Enclosures & Doors

A Welded Wire Solution.

RACK ENCLOSURES SECURE INVENTORY

A RackBack® enclosure will control access to, and help prevent theft of, your high-valued inventory items. A complete enclosure consists of panels on the back, ends, and top of the rack, with access doors on the front side.

SECURE INVENTORY BY COMPLETELY ENCLOSING YOUR PALLET RACK SYSTEM

Control access and prevent inventory shrinkage with our pallet rack enclosures. Modular sized welded wire panels are designed to match rack beam lengths; attach directly to rack uprights with standard brackets. Complete your rack enclosure with hinged or sliding doors.

CUSTOM-DESIGNED DOORS

Because of the variety of sizes we offer, our stock sliding or hinged doors work for nearly all rack enclosure applications. Should your project require a special size door, we offer custom design and build service.



POST PROTECTORS EXTEND THE LIFE OF YOUR PALLET RACK!

Post Protectors

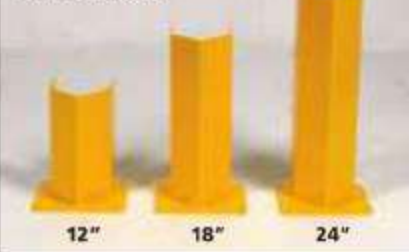

PROTECT YOUR PALLET RACK POSTS WITH POST PROTECTORS

Available in three heights (12", 18", and 24"), our post protectors are made of impact-resistant 3/16" steel uprights with a 1/4" steel base plate (9-1/2" x 8"), pre-drilled for easy installation. Each base plate accommodates a 5-1/2" wide by 4" deep rack upright post.

DOOR TRACK GUARDS

Shield overhead door track from lift truck damage with WireCrafters Door Track Guards. Available in 24" and 36" heights. Formed heavy duty 3/16" steel, with 1/2" base plate, anchors to floor and wall, allows doors to operate freely while protecting tracks from damage.

6208 Strawberry Lane
Louisville, KY 40214
800-626-1816
www.wirecrafters.com



WireCrafters®

WireCrafters

RapidGuard

Physical Barriers and Machine Guards

The All-New Lift Out Guarding System Installs Fast and Costs Less!

RapidGuard...

- Lift-out panels install 50% faster than conventional physical barrier products.
- Compliant with ANSI OSHA and RIA.
- Standard mesh is 1-1/4" x 3", 10-gauge wire welded on 8-gauge vertical wire. Alternate meshes available depending on your guarding requirements.
- Available in standard 6' and 8' panel heights.
- Frames are 1-1/4" x 1-1/4" x 13 gauge angle frame.
- Available with hinged or sliding doors.
- Available with tool-removable panels for OSHA compliance when necessary.
- Powder Coat Finish

*Add safety, security and value...
at the right price.*

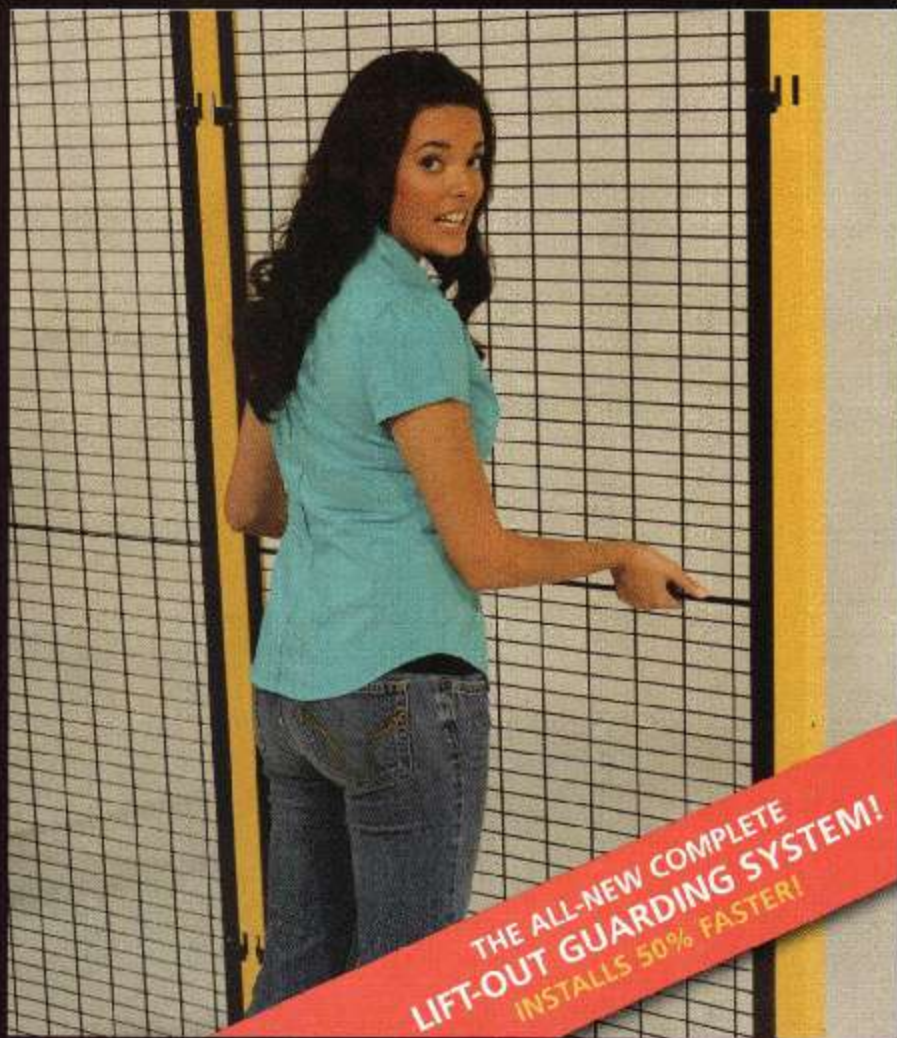

OSHA Compliant Tool Removable Panels



Sliding Door and Interlock

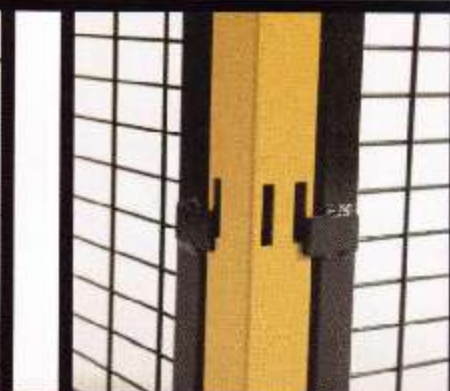

Drop-In Mounting Bracket

WireCrafters

RapidGuard

Physical Barriers and Machine Guards

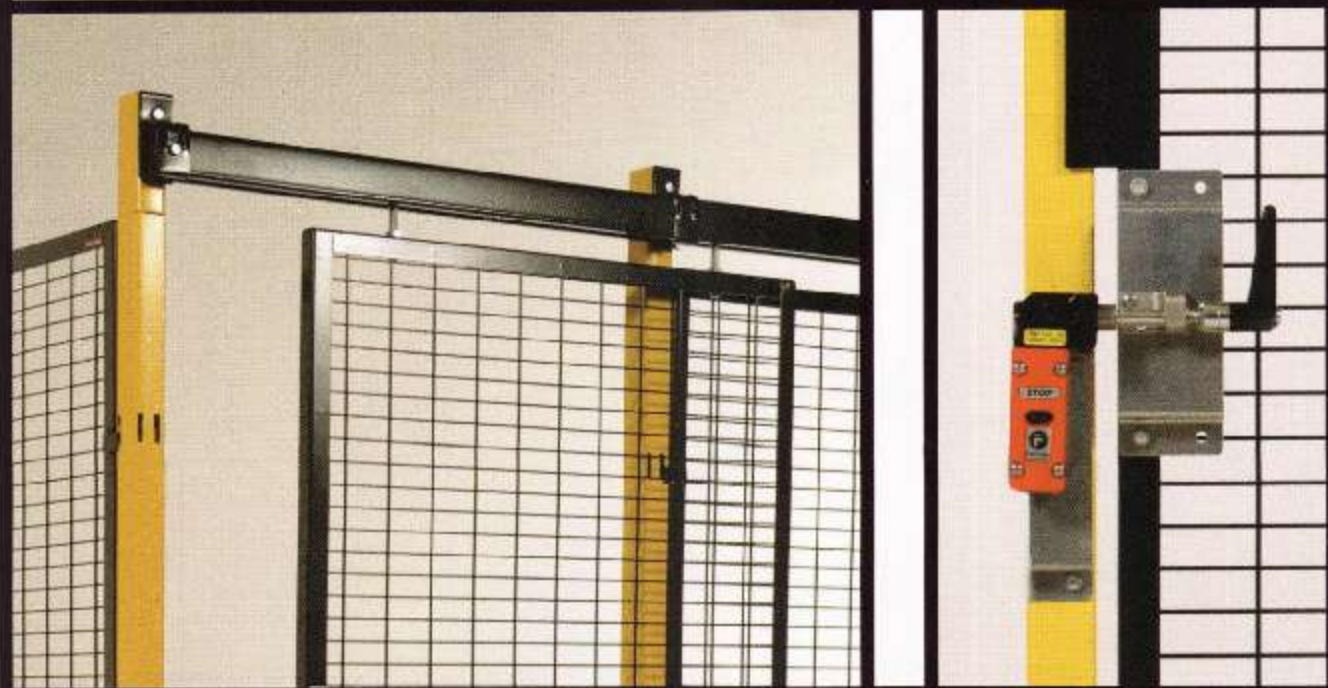

Easy-Glide Track System allows doors to open and close smoothly.

Optional Fortress® Interlocks

LIFT-OUT PANELS, POSTS AND DOORS

LIFT-OUT PANELS

WIDTH	HEIGHT
1'-0"	6'-2 13/16"
2'-0"	6'-2 13/16"
3'-0"	6'-2 13/16"
4'-0"	6'-2 13/16"
5'-0"	6'-2 13/16"
1'-0"	8'-1 1/4"
2'-0"	8'-1 1/4"
3'-0"	8'-1 1/4"
4'-0"	8'-1 1/4"
5'-0"	8'-1 1/4"

RUN POSTS

WIDTH	HEIGHT
2"	6'-6 3/4"
2"	8'-5 1/4"

CORNER POSTS

WIDTH	HEIGHT
2"	6'-6 3/4"
2"	8'-5 1/4"

SLIDING DOORS

WIDTH	HEIGHT
3'-0"	6'-2 13/16"
4'-0"	6'-2 13/16"
3'-0"	8'-1 1/4"
4'-0"	8'-1 1/4"

HINGED DOORS

WIDTH	HEIGHT
3'-0"	6'-2 13/16"
4'-0"	6'-2 13/16"
3'-0"	8'-1 1/4"
4'-0"	8'-1 1/4"

FLEXIBILITY

- Door Interlocks
- Polycarbonate Panels
- Solid Steel Panels
- Weld Curtain Panels



OPTIONAL
EXTERIOR
NON-
LOCKING
THUMB
TURN
LATCH
(SF-2)



OPTIONAL
INTERIOR
NON-
LOCKING
THUMB
TURN
LATCH
(SB-1)



6208 Strawberry Lane
Louisville, KY 40214
800-626-1816
www.wirecrafters.com



WireCrafters®

WireCrafters

Smart Storage

...for Condos, Offices, and Government Applications



WireCrafters

Storage Lockers

A Welded Wire Solution.



Introducing RapidWire.

A Strong Foundation for Growth. With nearly a half of century of experience in the safety and security markets, WireCrafters® and its tradition of quality, introduces the **RapidWire** line of welded wire lockers.

Strength. Quality. Value. RapidWire combines the flexibility of welded wire mesh with the proven strength of framed panels resulting in a quality WireCrafters' design with exceptional value.

Designed for On-Site Flexibility. Welded wire may be modified in the field making installations around obstructions like electrical conduits, heating ducts and water pipes easy. Because the wires are welded at every intersection, field modification does not affect structural integrity.

Easy to Install. Modular design, Starter and Add-On's, are supplied with pre-hung doors. This assures ease of installation and provides for the lowest total cost of ownership.

Two Styles. Single Tier, walk in style, or Double Tier over/under style units are available in standard and custom sizes.



Specs

MESH WIRE Thickness – 10 Gauge
Pattern – 2" x 2" (center to center) square welded wire (other meshes are available).

DOORS Framed in 1-1/4" x 1-1/4" x 13 gauge steel angle and pre-hung at the factory. All doors supplied with door strikes, padlock hasps, and 2-1/2" x 2-1/2" spun-pin hinges welded into place.

SIDE PANELS Framed with 1-1/4" x 1-1/4" x 13 gauge steel angle.

BACKS (optional)
10 gauge x 2" x 2" Welded Wire or 20 gauge galvanized sheet metal.

SHELVES/BOTTOMS (optional)
16 gauge formed galvanized steel.

TOPS (optional) Constructed of the same material as the standard locker. Standard design for tops is unframed while a framed option is available, consult factory.

WARRANTY 5 Years.

HARDWARE Standard grade 3/8" plated nuts and bolts will be supplied for assembly, 3/8" mechanical anchors for wall and floor mount.

FINISH All non-plated parts shall receive one prime coat of gray acrylic enamel electrostatically applied. Product is finished for interior applications. Materials are shipped loose and subject to nicks and scrapes while in transit. Touch up paint is provided. All lockers are shipped loose, ready for assembly.

Stock Sizes Available...

Other sizes available – consult your local sales representative.

WIDTH	DEPTH	HEIGHT	WIDTH	DEPTH	HEIGHT	WIDTH	DEPTH	HEIGHT
3'-0"	3'-0"	7'-6"	4'-0"	3'-0"	7'-6"	5'-0"	3'-0"	7'-6"
3'-0"	4'-0"	7'-6"	4'-0"	4'-0"	7'-6"	5'-0"	4'-0"	7'-6"
3'-0"	5'-0"	7'-6"	4'-0"	5'-0"	7'-6"	5'-0"	5'-0"	7'-6"

Wall-Mounted Garage Storage

When space is at a premium, WireCrafters' wall-mounted garage storage units deliver the best storage solution for limited space areas. Wall mounting feature allows ample room for even the largest vehicle to park, while maximizing the

garage's storage potential. Each unit is supplied with padlock lugs. Ideal for storing seasonal and bulky items that are not used regularly. Two sliding access doors. Standard size is 8' x 3' x 3', other sizes available. Ceilings are optional.



WireCrafters

Storage Lockers

A Welded Wire Solution.



TA-50 Military Lockers

In conjunction with the United States Military, WireCrafters has furnished many different designs of TA-50 lockers. All-welded construction with either sliding or hinged lockable doors and either woven/welded wire mesh or expanded metal provides the type of unit that will give the functional storage demanded by our military personnel. The units are ideal for storage of specialized tactical gear or standard issue items. Lockers may be ordered completely set up ready for placement, or knocked down ready to assemble. Let WireCrafters work with your personnel in designing and providing the very best TA-50 locker.



STYLE 840 Woven Wire and Solid Storage Lockers



WireCrafters' Woven Wire Storage Lockers are ideal for small enclosures. The units may be used individually or as a group. Two styles of lockers, single and double-tiered, are available in a variety of widths and depths. Doors are pre-hung in angle frames which connect directly to wall panels. Two-sided units fit in the corner of existing rooms. Free standing units may be installed anywhere.

Shop Lockers

- Provides secure but visible storage
- This heavy-duty unit features a three-point locking door, key lock and three full-width, 16-gauge galvanized steel shelves.
- Stand-alone or as multiple, side-by-side units.



WireCrafters

Bike Racks

Be Green. Be Clean with Bike Racks.

The Bike Stacker from WireCrafters...

- Staggered, formed bike trays hold any style bike upright and in position, while providing added clearance between stored bikes.
- Trays have exclusive tear drop tire slot (patent pending) that holds road, racing and mountain bikes in place.
- Residential, institutional and commercial use.
- Unique tray positioning design makes adjusting the bike tray spacing a snap.
- Bike trays are made of 16-gauge galvanized steel.
- Rack uprights are made of 1/8" steel angle.
- Rack horizontals are made of 14-gauge steel formed channel.
- Optional stop pins fit behind rear wheel to hold bikes forward in the tray. Optional stop pins may be necessary only for bikes of unusual size or tire width.



TEAR-DROP TIRE SLOT

OPTIONAL STOP PIN

Part No.	Depth	Width	Capacity
BK58	5' 8"	5' 0"	6
BK610	5' 8"	6' 0"	10
BK712	5' 8"	7' 0"	12
BK814	5' 8"	8' 0"	14

Custom sizes available.

NOTE: An 8' ceiling height is required to store full-size bicycles on the Bike Stacker's upper level raised bike trays.

The Wall Rider from WireCrafters...

- Strong...made of heavy-duty 1 1/2-gauge (1/8" thick) steel.
- Precision laser cut and formed.
- Easily installs...two 1/2" round holes for wall mounting.
- Ideal for residential, institutional and commercial use.
- Six-foot long, heavy-duty 1/4" vinyl-coated aircraft quality cable is permanently connected to mounting base for securing stored bicycles. Cable has permanent loop at free end for user's lock. Clear vinyl coating on cable protects bicycle finish during use.



NOTE: For best results when mounting to masonry walls, a horizontal header board may need to be installed (not included). See installation instructions or contact your sales representative for more information about mounting on masonry walls.



Mounting hardware not included.

Dimensions:

- Base Length: 6"
- Base Width: 3"
- Overall width including cable/lock eye: 4-3/4"
- Cable/lock eye: 3/4" round hole
- Arm projection from wall: 5-1/2"
- Arm width: 1"
- Arm length: 2"
- Arm length overall: 2-3/4"
- Cable: 1/4" vinyl coated aircraft quality 6' long cable

WireCrafters

6208 Strawberry Lane • Louisville, KY 40214 • 800-626-1816 • www.wirecrafters.com



WireCrafters®

DEA-APPROVED STORAGE

Ideally suited for...

- Pharmacies
- Pharmaceutical Companies
- Medical Facilities
- Distribution Centers
- Record Storage

DEA-Approved Storage...

When properly installed WireCrafters Style 840 Partitions meet the US Drug Enforcement Administration's requirements for physical security of Schedule III through V controlled substances as outlined in Title 21 CFR Sections 1301.72-1301.76 physical security controls.

Secured Storage/ Style 840 Features...

- Self closing, self locking doors.
- Wall and ceiling panels constructed of 10 gauge wire.
- Steel support posts 2" square.
- Posts have welded on base plates for lagging to the floor.
- Posts are set no more than ten feet apart.
- Walls have minimum 1-1/2" horizontal reinforcement at least every 60 inches.
- Standard mesh has 2" x 1" rectangular opening.
- Panels mount flush to floor.
- Heavy 3/8" hardware non-accessible from the exterior.
- Panels stack to any height
- Clear spanned ceilings up to 35' across.

WireCrafters offers these features plus years of experience providing approved enclosures to the drug industry. Let us help with your next project. Call today for a free consultation.



Drug Industry's Special Needs

As stipulated by 21 CFR 1301.72 storage areas for Schedule III through V controlled substances require a high level of security. Such installations have the following notable features.

Doors must be self closing and self locking. WireCrafters offers a number of standard and custom lock options to meet this requirement, as well a line of self closing doors with mechanical and powered operators.

Walls constructed of not less than No.10 steel fabric with openings not more than 2-1/2" across the square, mounted on steel posts, set no more than ten feet apart, with horizontal reinforcement. WireCrafters standard panels are maximum ten feet long, four or five feet tall, and are made of 2" x 1" opening 10 gauge steel wire. The frames of our panels satisfy the requirement for horizontal reinforcement every sixty inches.

Walls shall be mounted to posts at least one inch diameter, lagged to the floor. Standard posts are 2" square with base plates for floor anchoring welded to each. Lag bolts need to be pinned or brazed once installed.

Shall have a ceiling of same materials, or erected to reach the structural ceiling of the building. WireCrafters system uses the same panels in walls and ceilings. Furthermore, our system is so strong panels can be stacked between posts to reach most any building ceiling.

Panels mount flush to floor. A simple modification to the hole layout on our stock posts eliminates the sweep space allowing flush to floor mounting of the panels as required for this application.



WireCrafters

Dock Equipment

Driver Cages, Guardrail and Track Guard

Driver Cages

WireCrafters Driver Cage is a simple, cost effective, way of controlling access to your distribution center or factory floor. Partition walls made of wire mesh surround building entry doors, holding truck drivers in a defined area until met by company personnel. The wire partition's open but secure design gives you control without need for additional lighting, HVAC, or sprinkler systems. Driver Control Cages can be ordered in any size; and may be anchored to building walls, or free standing.

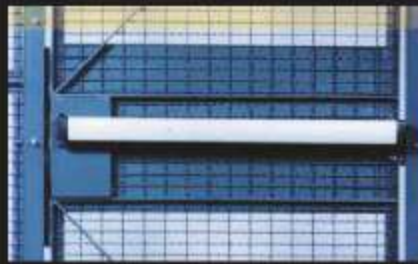

We recommend equipping your Driver Control Cage with a full-width push bar (shown above). Other locking options, including card readers and remote push buttons are available; call and ask for details.



DRIVER CAGE OPTIONS



CEILING

Full-span ceilings are also available when complete enclosure is required.



STEEL BENCH

Built of heavy-duty 10-gauge steel, this all-welded bench has baseplates for anchoring to the floor.



SERVICE WINDOW

Allows for easy exchange of paperwork and other small items.

WireCrafters

Dock Equipment

Driver Cages, Guardrail and Track Guard



Overhead Door Track Guard

Shield overhead door track from lift truck damage with WireCrafters Door Track Guards. Available in 24" and 36" heights. Formed heavy duty 3/16" steel, with 1/2" base plate, anchors to floor and wall, allows doors to operate freely while protecting tracks from damage.

Guardrail

Our guardrail system is an affordable means to define dock areas, restrict forklift traffic and protect active aisles-ways, driver cages and walls.



- Constructed from heavy-duty 11-gauge formed steel.
- Upright mounting columns are available in two styles – single rail (17" height) or double rail (43" height).
- Lift-out rails allow easy access to protected areas.
- Base plates for floor mounting are 10" square and come with four 7/8" holes for floor anchors (included).
- Rails are available in one-foot increments from 1' to 10' lengths.
- Competitively priced.
- For more information request our Protective Railing brochure.



6208 Strawberry Lane
Louisville, KY 40214
800-626-1816
www.wirecrafters.com



WireCrafters®