

The elegance of stainless steel components complements any design scheme, either in new construction or for renovations. Stainless steel toilet partitions provide a modern look and retain their gleaming beauty indefinitely. By adding a textured finish, increased resistance to vandalism can be achieved. Available in all four mounting styles.



**AccPack**  
PROTECTED SHIPPING

## STANDARD FINISH



#4 Satin

## OPTIONAL FINISH SELECTIONS:

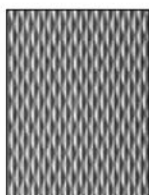

Diamond

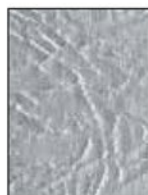

Leather Grain

## STANDARD FEATURES:

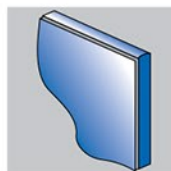

**Welded Corner**  
Corners of panels, pilasters and doors are welded to each other and to the adjacent face sheets.

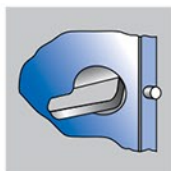

**Concealed Latch Mechanism**  
Housed entirely inside the door for durability, tamper-resistance and a clean look.

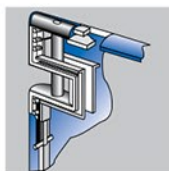

**Upper Door Bracket**  
Internal part of the door. A pin goes through door and bracket for three-point bearing and operates in a nylon bushing in upper hinge bracket.

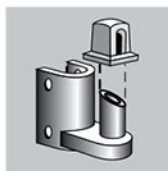

**Bottom Door Hinge**  
Gravity-positioning hinge provides safe, durable and maintenance free support.

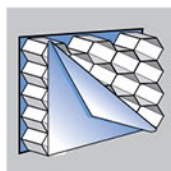

**Honeycomb Core**  
Made of cellular honeycomb. This type of core provides strong construction and sound attenuation.

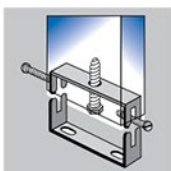

**One Piece Mounting Bracket**  
For faster, more precise and sturdier installation of Overhead Braced pilasters.

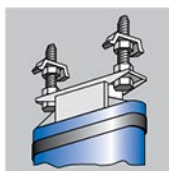

**Alternate Pilaster Mounting**  
This heavy gauge mounting is furnished on all ceiling-hung and floor-anchored pilasters.

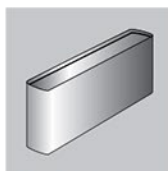

**Shoe Construction**  
One-piece stainless steel, type 304, with #4 satin finish trim shoes are hemmed top and bottom for rigidity and sleek appearance.

## OPTIONS:

- Stainless Steel Stirrup Brackets
- Stainless Steel Door Hardware
- Continuous Brackets
  - Anodized Aluminum
  - Stainless Steel
- Continuous Piano Hinges
- Ultimate Privacy™
- Wood Core

**Accurate**  
**EXPRESS**  
48-HOUR SHIPPING